

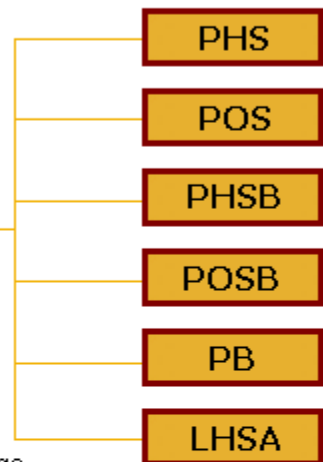

ROD END BEARINGS

막대 끝 방위



Rod End Bearings are compact, self-aligning spherical bushings that can support a large radial load and a bi-directional axial load at the same time. They have either a female thread in the body or a male thread on the body, and they can be easily assembled onto machines. The PB type consists of a spherical inner ring, an outer ring and a bushing and is assembled with a shaft and housing. The LHSA type are self-aligning Rod Ends consisting of a special die-cast zinc alloy body and a studded ball which has its axis at right angles to the body.

막대 끝 방위는 능축된다, 큰 광선 짐을 지원할 수 있고 양방향성 축 짐 동시에에는 몸안에 여성 실 또는 몸에 수나사가 있는 등근 투관을 맞춰 각자, 기계의 위에 쉽게 조립하고. 등근 안 반지, 외부 반지 및 투관이 PB 유형에 의하여 이루어져 있고 갱구에 모이고 주거 LHSA 유형은 특별한 거푸 집 던지기 아연 합금 몸을 이루어져 있는 막대 끝을 맞춰 각자 및 그것의 축선이 몸에 직각으로 있는 장식용 목을 박은 공에는 이다.



ROD END BEARINGS
Metric Dimensions

PHS Series

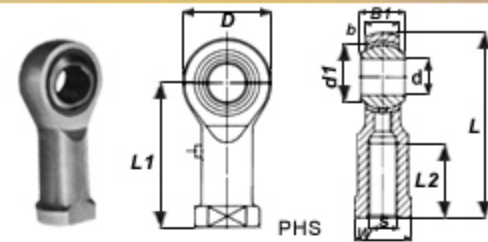

Dimension Table of PHS Series

Designation	Weight (g)	d	Thread (S)	Dimensions (mm)								Dynamic Load Capacity (kgf)	Static Load Capacity (kgf)
				D	B	B1	d1	L	L1	L2	W		
PHS 3	5.7	3	M3 X 0.5	12	4.5	6	5.2	27	21	10	5.5	180	370
PHS 4	11.9	4	M4 X 0.7	14	5.3	7	6.5	31	24	12	8	250	470
PHS 5	16.5	5	M5 X 0.8	16	6	8	7.7	35	27	14	9	330	580
PHS 6	25	6	M6 X 1	20	6.75	9	9	40	30	14	11	430	710
PHS 8	43	8	M8 X 1.25	24	9	12	10.4	48	36	17	14	710	1040
PHS 10	72	10	M10 X 1.5	28	10.5	14	12.9	57	43	21	17	1000	1360
PHS 12	107	12	M12 X 1.75	32	12	16	15.4	66	50	24	19	1330	1730
PHS 14	160	14	M14 X 2	36	13.5	19	16.9	75	57	27	22	1710	2130
PHS 16	210	16	M16 X 2	42	15	21	19.4	84	64	33	22	2140	2590
PHS 18	295	18	M18 X 1.5	46	16.5	23	21.9	93	71	36	27	2620	3080
PHS 20	380	20	M20 X 1.5	50	18	25	24.4	101	77	40	30	3140	3620
PHS 22	490	22	M22 X 1.5	54	20	28	25.8	109	84	43	32	3810	4260
PHS 25	750	25	M24 X 2	60	22	31	29.6	124	94	48	36	4710	7410
PHS 28	950	28	M27 X 2	66	25	35	32.3	136	103	53	41	5950	8870
PHS 30	1130	30	M30 X 2	70	25	37	34.8	145	110	56	41	6350	9400

Note : Special Pitch also available in some sizes





ROD END BEARINGS
Metric Dimensions

POS Series

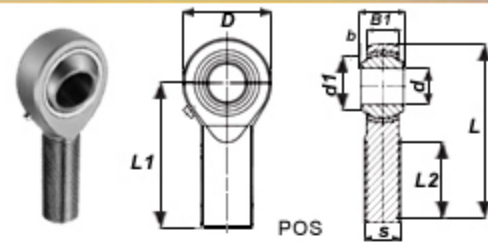

Dimension Table of POS Series

Designation	Weight (g)	d	Thread (S)	Dimensions (mm)							Dynamic Load Capacity (kgf)	Static Load Capacity (kgf)
				D	B	B1	d1	L	L1	L2		
POS 3	5	3	M3 X 0.5	12	4.5	6	5.2	33	27	15	180	370
POS 4	8.1	4	M4 X 0.7	14	5.3	7	6.5	37	30	17	250	470
POS 5	12.5	5	M5 X 0.8	16	6	8	7.7	41	33	20	330	580
POS 6	19	6	M6 X 1	20	6.75	9	9	46	36	22	430	710
POS 8	32	8	M8 X 1.25	24	9	12	10.4	54	42	25	710	1040
POS 10	54	10	M10 X 1.5	28	10.5	14	12.9	62	48	29	1000	1360
POS 12	85	12	M12 X 1.75	32	12	16	15.4	70	54	33	1330	1730
POS 14	126	14	M14 X 2	36	13.5	19	16.9	78	60	36	1710	2130
POS 16	185	16	M16 X 2	42	15	21	19.4	86	66	40	2140	2590
POS 18	260	18	M18 X 1.5	46	16.5	23	21.9	94	72	44	2620	3080
POS 20	340	20	M20 X 1.5	50	18	25	24.4	102	78	47	3140	3620
POS 22	435	22	M22 X 1.5	54	20	28	25.8	109	84	51	3810	4260
POS 25	650	25	M24 X 2	60	22	31	29.6	124	94	57	4710	7410
POS 28	875	28	M27 X 2	66	25	35	32.3	136	103	62	5950	8870
POS 30	1070	30	M30 X 2	70	25	37	34.8	145	110	66	6350	9400

Note : Special Pitch also available in some sizes





ROD END BEARINGS
Inch Dimensions

PHSB Series

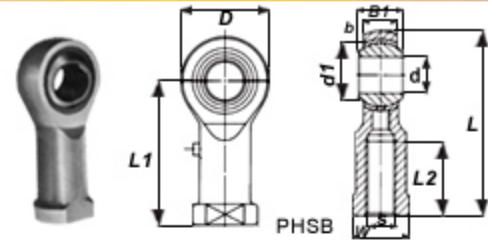

Dimension Table of PHSB Series

Designation	Weight (g)	d		Thread (S) Class 3B	D		B		Dimensions Inch (mm)				L		L1		L2		w		Dynamic Load Capacity (kgf)	Static Load Capacity (kgf)
		inch	mm		inch	mm	inch	mm	inch	mm	inch	mm	inch	mm	inch	mm	inch	mm	inch	mm		
PHSB 2	7	0.1250	3.175	.1380-32UNC	0.469	11.91	0.187	4.75	0.250	6.35	0.187	4.75	1.046	26.57	0.812	20.62	0.375	9.53	0.250	6.35	190	610
PHSB 2.5	11	0.1562	3.967	.1640-32UNC	0.562	14.27	0.219	5.56	0.281	7.14	0.249	6.32	1.156	29.36	0.875	22.23	0.375	9.53	0.281	7.14	260	860
PHSB 3	15	0.1900	4.826	.1900-32UNF	0.625	15.88	0.250	6.35	0.312	7.92	0.306	7.77	1.375	34.93	1.062	26.97	0.562	14.27	0.312	7.92	350	950
PHSB 4	25	0.2500	6.350	.2500-28UNF	0.750	19.05	0.281	7.14	0.375	9.53	0.355	9.02	1.687	42.85	1.312	33.32	0.750	19.05	0.375	9.53	470	1380
PHSB 5	36	0.3125	7.938	.3125-24UNF	0.875	22.23	0.344	8.74	0.437	11.10	0.447	11.35	1.812	46.02	1.375	34.93	0.750	19.05	0.437	11.10	690	1720
PHSB 6	61	0.3750	9.525	.3750-24UNF	1.000	25.40	0.406	10.31	0.500	12.70	0.517	13.13	2.125	53.98	1.625	41.28	0.937	23.80	0.562	14.27	940	2260
PHSB 7	81	0.4375	11.112	.4375-20UNF	1.125	28.58	0.437	11.10	0.562	14.27	0.586	14.88	2.375	60.33	1.812	46.02	1.062	26.97	0.625	15.88	1150	2730
PHSB 8	133	0.5000	12.700	.5000-20UNF	1.312	33.32	0.500	12.70	0.625	15.88	0.698	17.73	2.781	70.64	2.125	53.98	1.187	30.15	0.750	19.05	1510	3800
PHSB 10	190	0.6250	15.875	.6250-18UNF	1.500	38.10	0.562	14.27	0.750	19.05	0.839	21.31	3.250	82.55	2.500	63.50	1.500	38.10	0.875	22.23	2040	4100
PHSB 12	285	0.7500	19.050	.7500-16UNF	1.750	44.45	0.687	17.45	0.875	22.23	0.978	24.84	3.750	95.25	2.875	73.03	1.750	44.45	1.000	25.40	2910	5760
PHSB 16	1000	1.0000	25.400	1.2500-12UNF	2.750	69.85	1.000	25.40	1.375	34.925	1.269	32.23	5.500	139.70	4.125	104.78	2.125	53.98	1.500	38.10	6050	8850





ROD END BEARINGS
Inch Dimensions

POSB Series

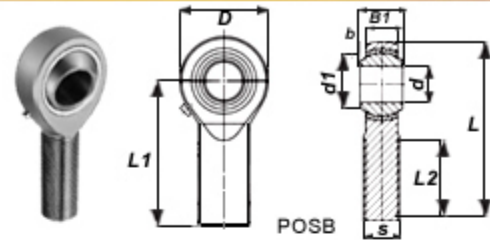

Dimension Table of POSB Series

Designation	Weight (g)	d		Thread (S) Class 3B	D		B		Dimensions Inch (mm)				L		L1		L2		Dynamic Load Capacity (kgf)	Static Load Capacity (kgf)
		inch	mm		inch	mm	inch	mm	inch	mm	inch	mm	inch	mm	inch	mm	inch	mm		
POSB 2	5.5	0.1250	3.175	.1380-32UNC	0.469	11.91	0.187	4.75	0.250	6.35	0.187	4.75	1.172	29.77	0.937	23.80	0.500	12.70	190	230
POSB 2.5	9	0.1562	3.967	.1640-32UNC	0.562	14.27	0.219	5.56	0.281	7.14	0.249	6.32	1.406	35.71	1.125	28.58	0.625	15.88	260	350
POSB 3	12.5	0.1900	4.826	.1900-32UNF	0.625	15.88	0.250	6.35	0.312	7.92	0.306	7.77	1.563	39.70	1.250	31.75	0.750	19.05	350	510
POSB 4	22	0.2500	6.350	.2500-28UNF	0.750	19.05	0.281	7.14	0.375	9.53	0.355	9.02	1.937	49.20	1.562	39.67	1.000	25.40	470	930
POSB 5	37	0.3125	7.938	.3125-24UNF	0.875	22.23	0.344	8.74	0.437	11.10	0.447	11.35	2.312	58.72	1.875	47.63	1.250	31.75	690	1490
POSB 6	55	0.3750	9.525	.3750-24UNF	1.000	25.40	0.406	10.31	0.500	12.70	0.517	13.13	2.438	61.93	1.938	49.23	1.250	31.75	940	2260
POSB 7	78	0.4375	11.112	.4375-20UNF	1.125	28.58	0.437	11.10	0.562	14.27	0.586	14.88	2.688	68.28	2.125	53.98	1.375	34.93	1150	2730
POSB 8	120	0.5000	12.700	.5000-20UNF	1.312	33.32	0.500	12.70	0.625	15.88	0.698	17.73	3.094	78.59	2.438	61.93	1.500	38.10	1510	3800
POSB 10	184	0.6250	15.875	.6250-18UNF	1.500	38.10	0.562	14.27	0.750	19.05	0.839	21.31	3.375	85.73	2.625	66.68	1.625	41.28	2040	4100
POSB 12	293	0.7500	19.050	.7500-16UNF	1.750	44.45	0.687	17.45	0.875	22.23	0.978	24.84	3.750	95.25	2.875	73.03	1.750	44.45	2910	5760
POSB 16	1100	1.0000	25.400	1.2500-12UNF	2.750	69.85	1.000	25.40	1.375	34.925	1.269	32.23	5.500	139.70	4.125	104.78	2.125	53.98	6050	11500

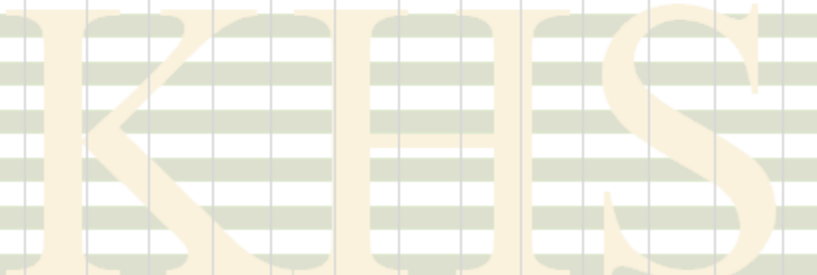



ROD END BEARINGS
Metric Dimensions

LHSA Series

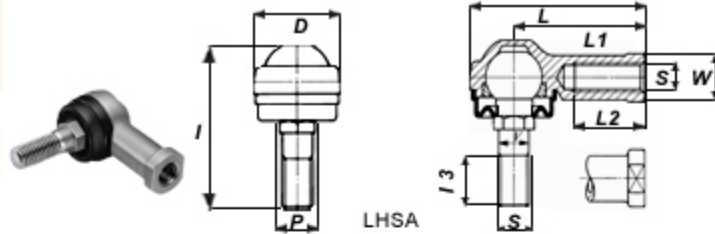

Dimension Table of LHSA Series

Designation	Weight (g)	Thread S	Dimensions (mm)									Static Load Capacity (kgf)
			V	D	L	L1	L2	W	L	P	I 3	
LHSA 4	11	M4 X 0.7	4	14	25.5	18	8	8	19.5	5.5	5	90
LHSA 5	27	M5 X 0.8	5	17	38.5	30	16	10	32.5	8	10	120
LHSA 6	27	M6 X 1	6	19	39.5	30	16	10	32.5	8	10	170
LHSA 8	64	M8 X 1.25	8	24	48	36	19	14	41.5	10	12.5	440
LHSA 10	106	M10 X 1.25	10	28	57	43	23	17	49	12	17	750
LHSA 10 M	106	M10 X 1.5	10	28	57	43	23	17	49	12	17	750
LHSA 12	180	M12 X 1.75	12	34	67	50	27	19	64	14	20	1010
LHSA 14	260	M14 X 2	14	38	76	57	30	22	72	17	22	1490
LHSA 16	300	M16 X 2	16	40	84	64	36	22	74	19	23	1990
LHSA 18	445	M18 X 1.5	18	45	93.5	71	40	27	84	22	25	2610
LHSA 20	580	M20 X 1.5	20	49	101.5	77	43	30	90.5	24	27	3210
LHSA 22	765	M22 X 1.5	22	54	111	84	47	32	99	27	30	4050

